

# SONTH

武汉尚斯机电有限公司  
**Sonth (HK) Industrial Co.,Ltd**

## SGP22-180: dc planetary gear motor



### Description

1. Diameter: 22mm
2. Voltage: 12V (6~24V)
3. Input speed: 6500rpm (6000~18000rpm)
4. Reduction ratio: 1/4, 1/16, 1/64, 1/256, 1/1024...
5. Output speed: 5~500rpm
6. Rated torque: 0.2~4.0Kg.cm
7. Can match encoder
8. Specs can be customized for you

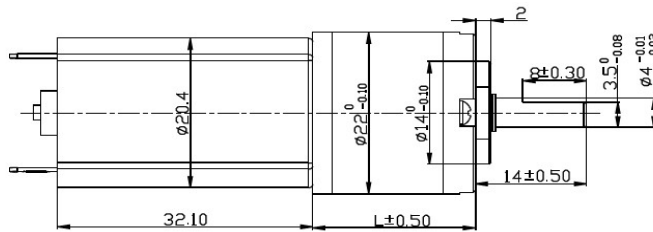
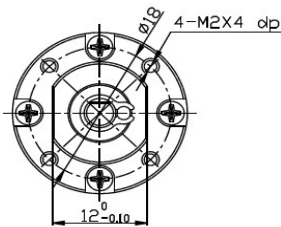

Reduction Ratio	Gearbox Length L= mm	No load Speed/rpm	Voltage 12V, Input 6500rpm (6V,9V,12V,24)				Stall	
			At load Speed/rpm	Current/A	Torque/Kg.cm	Power/W	Current/A	Torque/Kg.cm
1/4	17	1625	1370	0.25	0.026	1.5	0.8	0.1
1/5	17	1370	1090	0.25	0.072	1.5	0.8	0.1
1/16	17	400	320	0.25	0.1	1.5	0.8	0.2
1/19	17	340	250	0.25	0.15	1.5	0.8	0.3
1/23	17	290	220	0.25	0.25	1.5	0.8	0.7
1/64	20.5	100	80	0.25	0.30	1.5	0.8	0.7
1/76	20.5	85	65	0.25	0.35	1.5	0.8	0.7
1/90	20.5	70	56	0.25	0.45	1.5	0.8	1.0
1/107	20.5	60	48	0.25	0.55	1.5	0.8	1.0
1/256	24.1	25	20	0.25	0.70	1.5	0.8	2.0
1/304	24.1	20	16	0.25	0.85	1.5	0.8	2.0
1/361	24.1	18	14	0.25	1.1	1.5	0.8	3.0
1/428	24.1	15	12	0.25	1.3	1.5	0.8	3.0
1/509	24.1	13	11	0.25	1.5	1.5	0.8	3.0
1/1024	27.6	6	5	0.25	2.0	1.5	0.8	5.0
1/1216	27.6	5	4	0.25	2.5	1.5	0.8	5.0
1/1444	27.6	4	3.5	0.25	3.0	1.5	0.8	5.0
1/1714	27.6	3.5	3	0.25	3.5	1.5	0.8	8.0
1/2036	27.6	3	2.5	0.25	4.0	1.5	0.8	8.0
1/2418	27.6	2.5	2	0.25	4.0	1.5	0.8	8.0

**Tel:** +86-27-87153161

**Fax:** +86-27-51893787

**Address:** 26th Floor, Block A, LongAn GangHui City,  
 MinZu Road, Optical Vally, WuHan, HuBei, China

**Email:** cassy@sonth-industrial.com

**Web:** www.sonth-industrial.com; www.sonth123.com