

SGP42-42BL: dc brushless planetary gear motor

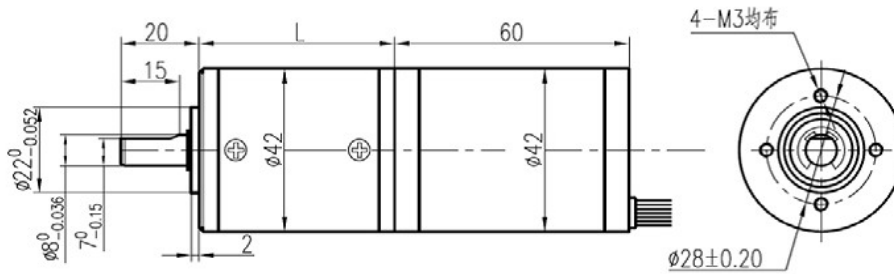

Description

1. Diameter: 42mm
2. Voltage: 24V
3. Input speed: 3000rpm
4. Reduction ratio: 1/3.8, 1/5, 1/15, 1/19, 1/24...
5. Output speed: 10~550rpm
6. Rated torque: 2~50Kg.cm
7. Built-out drive (8 wires)
8. Specs can be customized for you



Reduction Ratio	Gearbox Length L= mm	No load Speed/rpm	Voltage 24V, Input 3000rpm				Stall	
			Speed/rpm	Current/A	Torque/Kg.c	Power/W	Current/A	Torque/Kg.c
1/3.8	35	785	550	1.5	2.0	15	4.0	15
1/5	35	615	430	1.5	2.5	15	4.0	15
1/15	46	200	140	1.5	7.0	15	4.0	60
1/19	46	158	111	1.5	9.0	15	4.0	60
1/24	46	125	88	1.5	12	15	4.0	60
1/56	56	54	38	1.5	25	15	4.0	120
1/71	56	42	30	1.5	30	15	4.0	120
1/91	56	33	23	1.5	40	15	4.0	120
1/116	56	26	20	1.5	40	15	4.0	120
1/212	56	14	12	1.5	50	15	4.0	150
1/271	56	11	10	1.5	50	15	4.0	150

TEL: +86-755-89480927
 FAX: +86-755-88366423
 Web: www.sonth123.com
 Msn: sonth123@hotmail.com