

S20PM: dc stepper motor

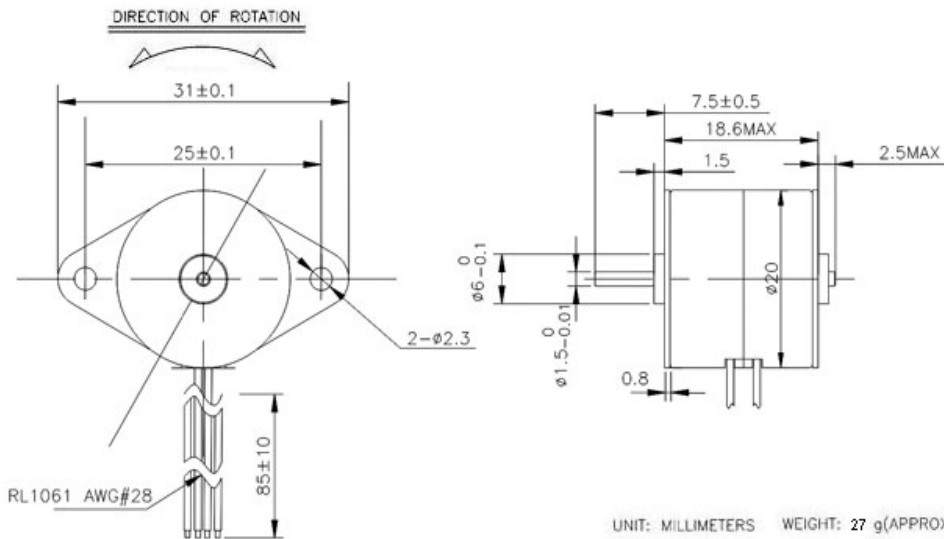

Description

- 1.Size: 20*18.6 mm
- 2.Voltage: 12V
- 3.Step angle: 18°
- 4.Phase: 2-2
- 5.Specs can be customized for you



Voltage V	Step Angle		Starting/pps	Max Frequency		Torque	
	degree	Phase		Response/pps	Resistance/Ω	Pull-in/g.cm	Pull-out /g.cm
12	18°	2-2	300	2200	30	25	76

TEL:+86-755-89480927
 FAX:+86-755-88366423
 Web: www.sonth123.com
 Msn: sonth123@hotmail.com