

SGP36-36BL: dc brushless planetary gear motor

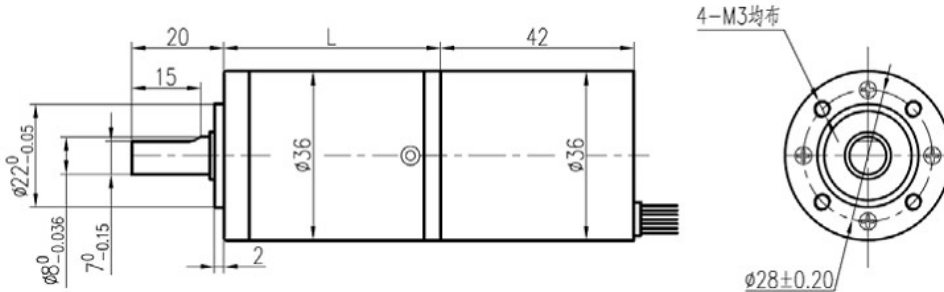

Description

1. Diameter: 36mm
2. Voltage: 24V
3. Input speed: 4000rpm
4. Reduction ratio: 1/3.7, 1/5.2, 1/14, 1/19, 1/27...
5. Output speed: 14-755rpm
6. Rated torque: 1-30Kg.cm
7. Built-out drive (8 wires), built-in drive (5 wires)
8. Specs can be customized for you



Reduction Ratio	Gearbox Length L= mm	No load Speed/rpm	Voltage 24V, Input 4000rpm				Stall	
			Speed/rpm	Current/A	Torque/Kg.cm	Power/W	Current/A	Torque/Kg.cm
1/3.7	31	1078	755	0.45	1	10	3.0	10
1/5.2	31	772	541	0.45	1.5	10	3.0	10
1/14	38.5	286	200	0.45	3.5	10	3.0	35
1/19	38.5	211	147	0.45	4.5	10	3.0	35
1/27	38.5	148	104	0.45	6.5	10	3.0	35
1/51	48.5	78	55	0.45	11	10	3.0	75
1/71	48.5	56	39	0.45	16	10	3.0	75
1/100	48.5	40	30	0.45	22	10	3.0	75
1/139	48.5	29	23	0.45	25	10	3.0	75
1/189	55.5	21	18	0.45	30	10	3.0	90
1/264	55.5	15	14	0.45	30	10	3.0	90

TEL:+86-755-89480927
 FAX:+86-755-88366423
 Web: www.sonth123.com
 Msn: sonth123@hotmail.com