

SBL36-40: dc brushless motor

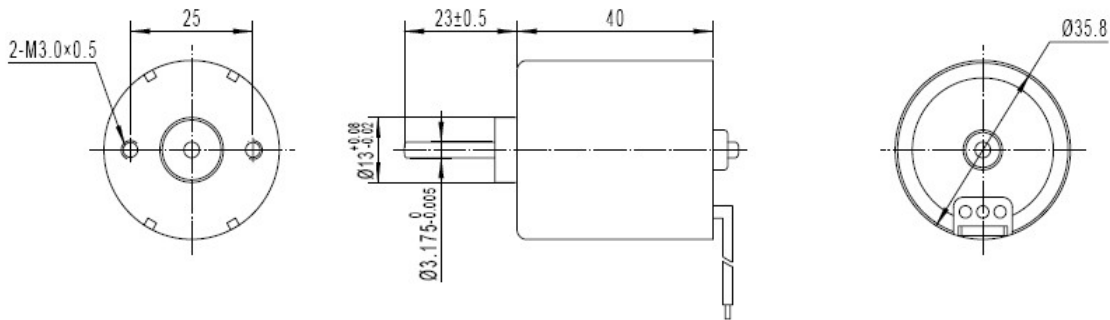

Description

- 1.Size: 36*40 mm
- 2.Voltage: 12V/24V
- 3.No load speed: 5000rpm/4800rpm
- 4.Rated torque: 100g.cm/200g.cm
- 5.Sleeve bearing
- 6.Built-in drive (6 wires)
- 7.PWM:Pulse-Width Modulation
- 8.CW/CCW
- 9.Overload protection
- 10.Life time:>10000 hours



Voltage V	No load		At load				Stall	
	Speed/rpm	Current/A	Speed/rpm	Current/A	Torque/g.cm	Power/W	Current/A	Torque/g.cm
12	5000	0.7	4000	1.2	100	5	2.2	400
24	4800	0.3	3900	0.8	200	8	3.0	1100

TEL:+86-755-89480927
 FAX:+86-755-88366423
 Web: www.sonth123.com
 Msn: sonth123@hotmail.com