

### SGP28-28SH: dc hybrid stepper planetary gear motor

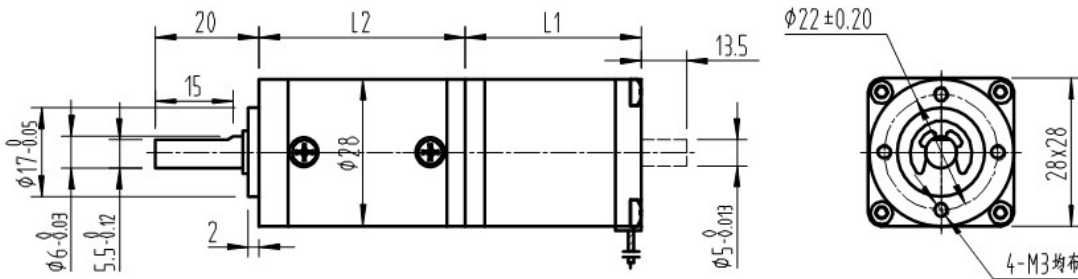

#### Description

1. Diameter: 28mm
2. Voltage: 6V (4~24V)
3. Step angle: 1.8°
4. Reduction ratio: 1/5, 1/14, 1/51, 1/100, 1/264, 1/369....
5. Torque: 1~40Kg.cm
6. Stepper motor L1=32/45/51 mm
7. Number of phase: 2 or 4 (2-4wires, 4-6wires)
8. Specs can be customized for you



Reduction Ratio	Gearbox Length L2= mm	Step Angle degree	2 Phase ,Voltage 6V (4V,12V,24V)			
			Current A	Resistance $\Omega$	Torque	
					Pull-in/Kg.cm	Pull-out/Kg.cm
1/5	31	1.8°/5	0.67	9	1.2	6
1/14	40	1.8°/14	0.67	9	1.2	16
1/51	49	1.8°/51	0.67	9	1.2	32
1/100	49	1.8°/100	0.67	9	1.2	32
1/264	58	1.8°/264	0.67	9	1.2	40
1/369	58	1.8°/369	0.67	9	1.2	40

TEL: +86-755-89480927  
 FAX: +86-755-88366423  
 Web: [www.sonth123.com](http://www.sonth123.com)  
 Msn: [sonth123@hotmail.com](mailto:sonth123@hotmail.com)